

TECHNICAL DATA SHEET

REGUPOL® 3912 ACOUSTIC UNDERLAYMENT FOR REFURBISHMENTS AND TIMBER BASED CONSTRUCTIONS

PRODUCT DESCRIPTION

Regupol® 3912 is a tough, resilient acoustic underlay manufactured from PUR Foam and is ideally suited to refurbishment and timber based constructions to comply with Part E. It can also be used for new build but consultation with CMS Danskin Acoustics Technical Support Team is recommended prior to specification.

BENEFITS

- Independent Test Data available for both site and field tests to show compliance with both Approved Document E and Section H of the Building Regulations.
- When used in acoustic floors under Part E of the Building Regulations and Robust Details is accepted by the NHBC
- Standard thickness 6mm thick, although other thicknesses are available upon request
- Offers long term performance without collapse or “bottoming” out under high point loads
- Resistant to ageing and deformation
- Quick and easy to install. Simply bond to the subfloor beneath the final floor finish
- Reduces construction heights
- Suitable for both new build and refurbishments, although can be used for new build also
- High quality and exact material thickness guaranteed
- Suitable for use with under floor heating
- Very comfortable under foot
- Manufactured using Recycled Materials and 100% recyclable



PHYSICAL INFORMATION

Roll length	15m (Non standard lengths are available upon request)
Roll width	1m
Material thickness (mm)	6

TECHNICAL DATA*

Regupol® 3912 conforms to the following specifications:

Colour	Black
Density	approx 370 kg/m ³
Tensile strength (DIN 53571)	approx 0.4 N/mm ²
Elongation at break (DIN 53571)	approx 45%
Temperature resistance	-40 to +110°C
Thermal Conductivity	approx 0.12 W/mk
Thermal resistance (DIN 52612)	1/λ = 0.049 K/W
Impact sound insulation: ΔL _w	23dB
Airborne sound insulation (DnT,w + Ctr)	52.3dB (mean average)*
Impact sound insulation (LnT,w)	49.5dB (mean average)*

* Values based on independent field test data, available on request

INSTALLATION GUIDELINES

Detailed Installation Guidelines are available upon request. Also, all rolls of Regupol® 3912 come supplied with installation guidelines. Application examples are shown overleaf. Please contact CMS Danskin Acoustics for a list of approved and qualified installers.

N.B. Please ensure all floor finishes e.g. carpet and hardwood floors, etc. are laid in accordance with the manufacturer's instructions.

STORAGE

Regupol® 3912 must be stored indoors. At no time must the Regupol® 3912 be exposed to the elements of the weather. Regupol® 3912 must always be kept dry, otherwise moisture will build up in the material and will subsequently make bonding to the subfloor very difficult. Moisture will also cause the material to curl and ripple at the edges once unrolled. It is recommended that the polythene packaging be removed in the area where it shall be applied.

INSTALLATION SERVICE

In addition to supply of this product CMS Danskin Acoustics can provide a listing of competitively- priced approved installers that service anywhere in the UK. Use of this service ensures that installation is performed to the highest standards by tradesmen fully experienced in the specialist skills of fitting CMS Danskin Acoustics materials correctly. For further details contact our technical team on 01925 577711.

INSTALLATION EXAMPLES

Example 1*

Airborne Sound Insulation (DnTw + Ctr) - 52.3db (mean average)

Impact Sound Insulation (LnTw) - 49.5db (mean average)

* Please refer to KR Associates Report Ref. KR02805 for full report

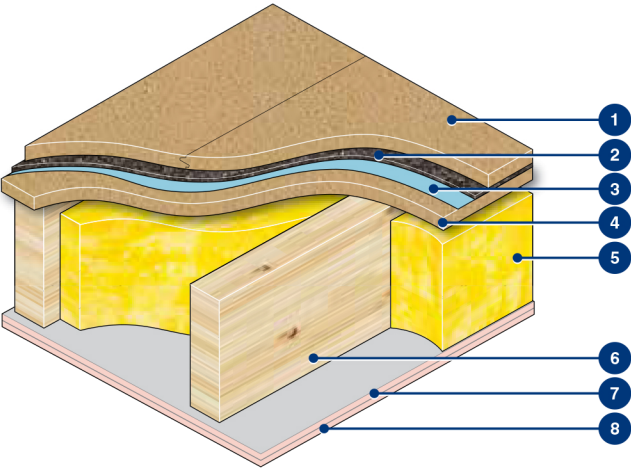

Ceiling Detail

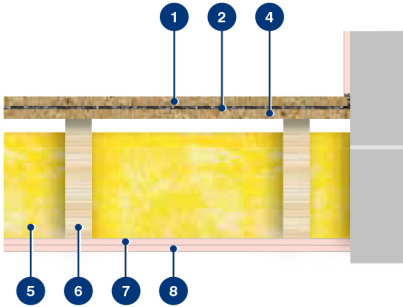

- 1 18mm T&G Chipboard or
**Carpet Floor Finish
- 2 Regupol® 3912
- 3 Regupol® Regubond 100 or
equal approved
- 4 18mm T & G Chipboard
mechanically fixed joists
- 5 9.8kg/m³ loft roll. 200mm
thick
- 6 225mm deep x 50mm wide
wooden joists at 400mm
centres
- 7 1 layer of Fireline/Firesield
- 8 1 layer of standard
plasterboard

Example 2*

Airborne Sound Insulation (DnTw + Ctr) - 53db (mean average)

Impact Sound Insulation (LnTw) - 52db (mean average)

* Please refer to Pace Report Ref. PAC-07-0127-RP1 for full report

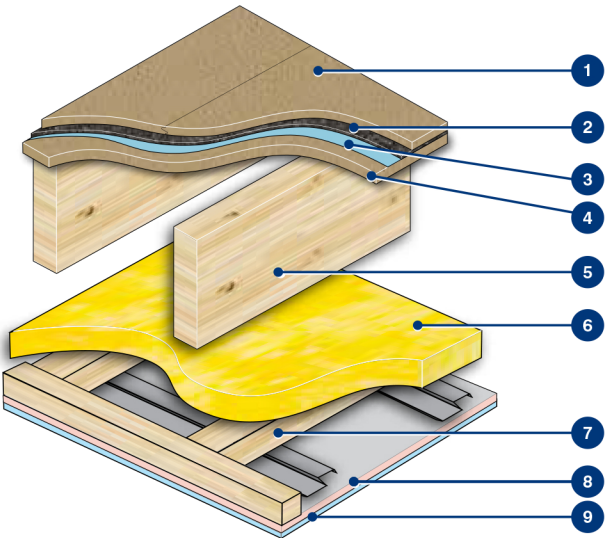

All illustrations for example purposes only

Ceiling Detail

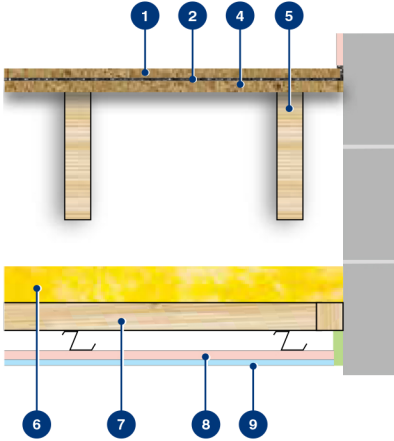

- 1 18mm T&G Chipboard or
**Carpet Floor Finish
- 2 Regupol® 3912
- 3 Regupol® Regubond 100 or
equal approved
- 4 22mm Chipboard
- 5 250mm deep x 50mm wide
joists
- 6 Minimum 75mm mineral
wool minimum 45kg/m²
- 7 Suspended 75mm timber
frame ceiling on resilient bar
- 8 1 x 19mm Gyproc Plank
- 9 1 x 12.5mm SoundBloc

** Carpet can be laid directly over the Regupol® 3912 and can either be bonded directly to the Regupol® 3912 or installed in the same manner as a standard carpet installation